



Linear motion, low profile: height of 20 mm

Note: Suitable for flat mounting.

APPLICATIONS:

Used in medical equipment, gaming consoles, retail displays, and compact drawers, as well as industrial machinery, commercial displays, and residential furniture.

MODEL 2415 QUICK REFERENCE

Side Space: 0.31" [8 mm]

Length: 8" - 22"

Height: 0.79" [20 mm]

Load: 40 lbs.

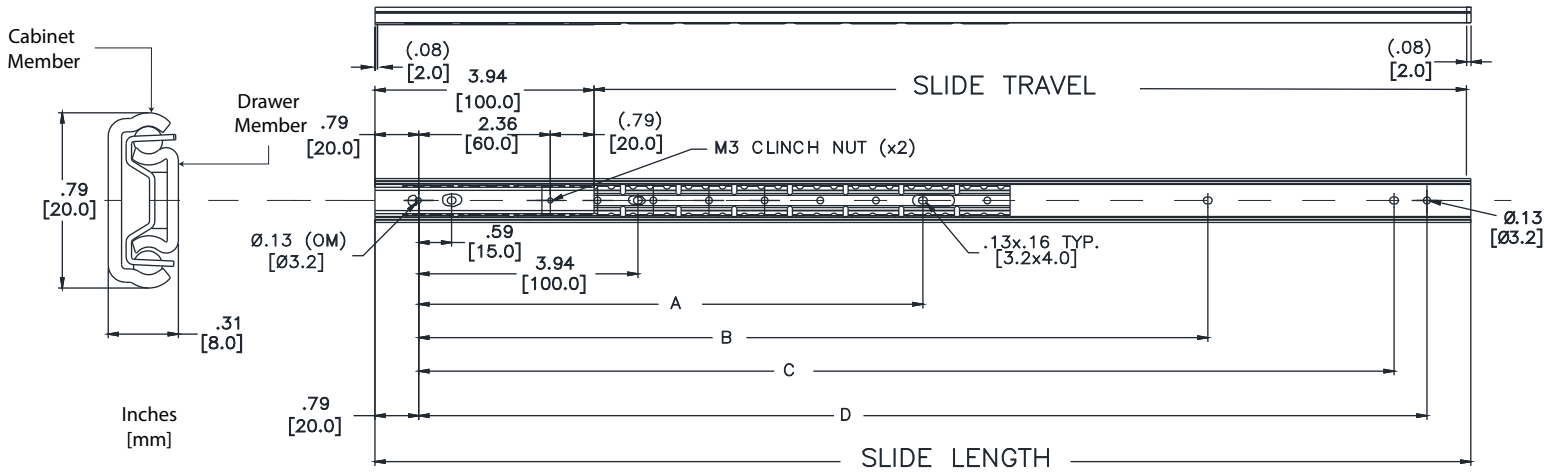

Finish Electro-zinc plating (C)

Lengths Even lengths 8"-22"
[200 mm to 550 mm]

Travel See chart

Height 0.79 [20 mm]

Load Rating 40 lbs. [18.5 kg]*

Side Space 0.31 +0.030/-0.000"
[8.0 mm +0.76/-0.00]

Mounting Side and flat mount

Hardware M3 Screws

Ball Bearing Steel

Features Linear Motion

PART NUMBER	SLIDE LENGTH	SLIDE TRAVEL	A	B	C	D
C 2415-8	7.87[200]	3.78[96]	-	-	5.71[145]	6.30[160]
C 2415-10	9.84[250]	5.75[146]	-	-	7.68[195]	8.27[210]
C 2415-12	11.81[300]	7.72[196]	-	6.30[160]	9.65[245]	10.24[260]
C 2415-14	13.78[350]	9.69[246]	-	8.27[210]	11.61[295]	12.21[310]
C 2415-16	15.75[400]	11.65[296]	-	10.24[260]	13.58[345]	14.17[360]
C 2415-18	17.72[450]	13.62[346]	8.07[205]	12.21[310]	15.55[395]	16.14[410]
C 2415-20	19.69[500]	15.59[396]	9.06[230]	14.17[360]	17.52[445]	18.11[460]
C 2415-22	21.65[550]	17.56[446]	10.04[255]	16.14[410]	19.49[495]	20.08[510]

Notes:

- *Load rating based on an 18" slide on a 18" wide drawer cycled 80,000 times.
- Recommended fixing: M3 screws

Installation Instructions

Install Cabinet Member

1. Secure the cabinet member into the cabinet using M3 screws (wood screws are included in the D Pack configuration).
2. Ensure the slides are parallel.
3. The cabinet member should be flush or recessed from the front surface. (Figure 1)

Note: All mounting holes must be used to achieve the maximum load rating.

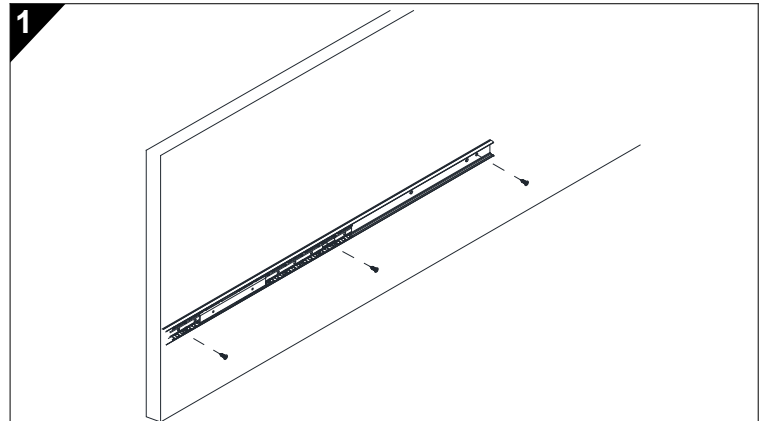

Installation Instructions

Install Drawer Member

4. Attach the inner member moving component (drawer or tray) to the inner member PEMS using M3 machine screws (not included).

Maximum screw length =
Attachment plate thickness + 3 mm. (Figure 2)

5. Side Mount Installation: The slide should be installed along the centerline of the drawer or shelf. (Figure 3)
6. Flat Mount Installation: The slide should be installed at a minimum distance of 3/8" (9.5 mm) from the drawer or shelf edge. (Figure 4)

Slide Ordering Instructions

Complete your slide order for model 2415 by specifying the following:

	200	Each	C	2415	-8	D
Total Required Slides						
Slide Finish						
Slide Model						
Slide Length						
Polybag Packaging						

For the most current technical information visit www.accuride.com

Packaging

Distributor (D) Pack: All lengths are packaged 10 pairs per box. Each polybag contains one pair of slides, an installation sheet and M3 wood screws for cabinet member.

Bulk (P) Pack: All lengths are packaged 20 pairs per box. Installation screws are not included.

Specifications

Slide members: Cold rolled steel
Ball retainers: Cold rolled steel
Ball bearings: Carburized steel
RoHs Compliant

Note: Specification, materials, prices, terms and delivery are subject to change without notice.

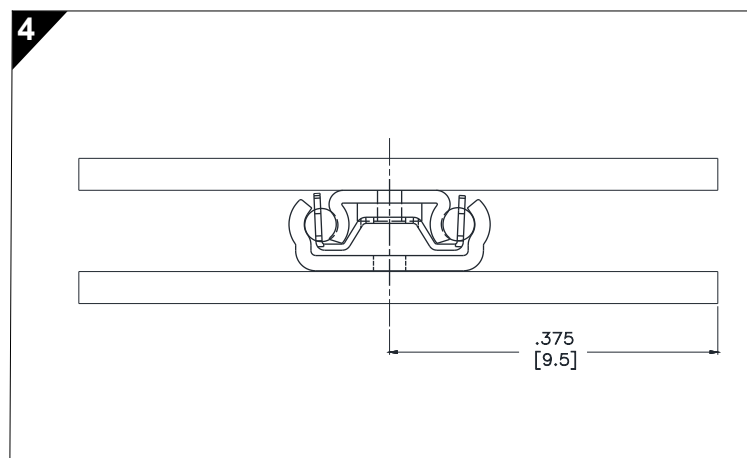
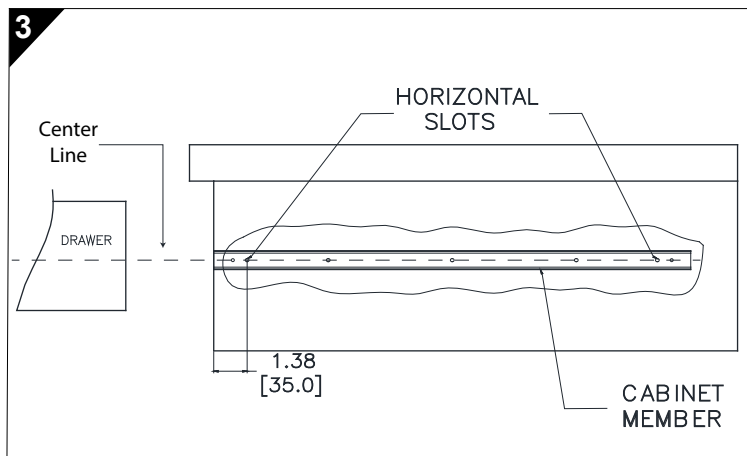
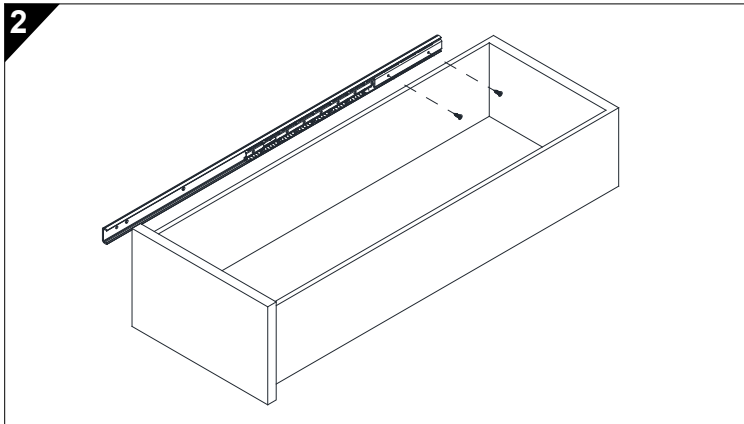

Accuride

ACCURIDE INTERNATIONAL INC.

12311 Shoemaker Avenue
Santa Fe Springs, CA 90670

TEL (888) 491-7112

FAX (562) 903-0208

www.accuride.com

Manufacturing, Engineering, and Sales

United States • Germany • Japan • Mexico • United Kingdom • China

Copyright © 2017-2025 Accuride International Inc. 3700-9615-MK215-R3-0425